

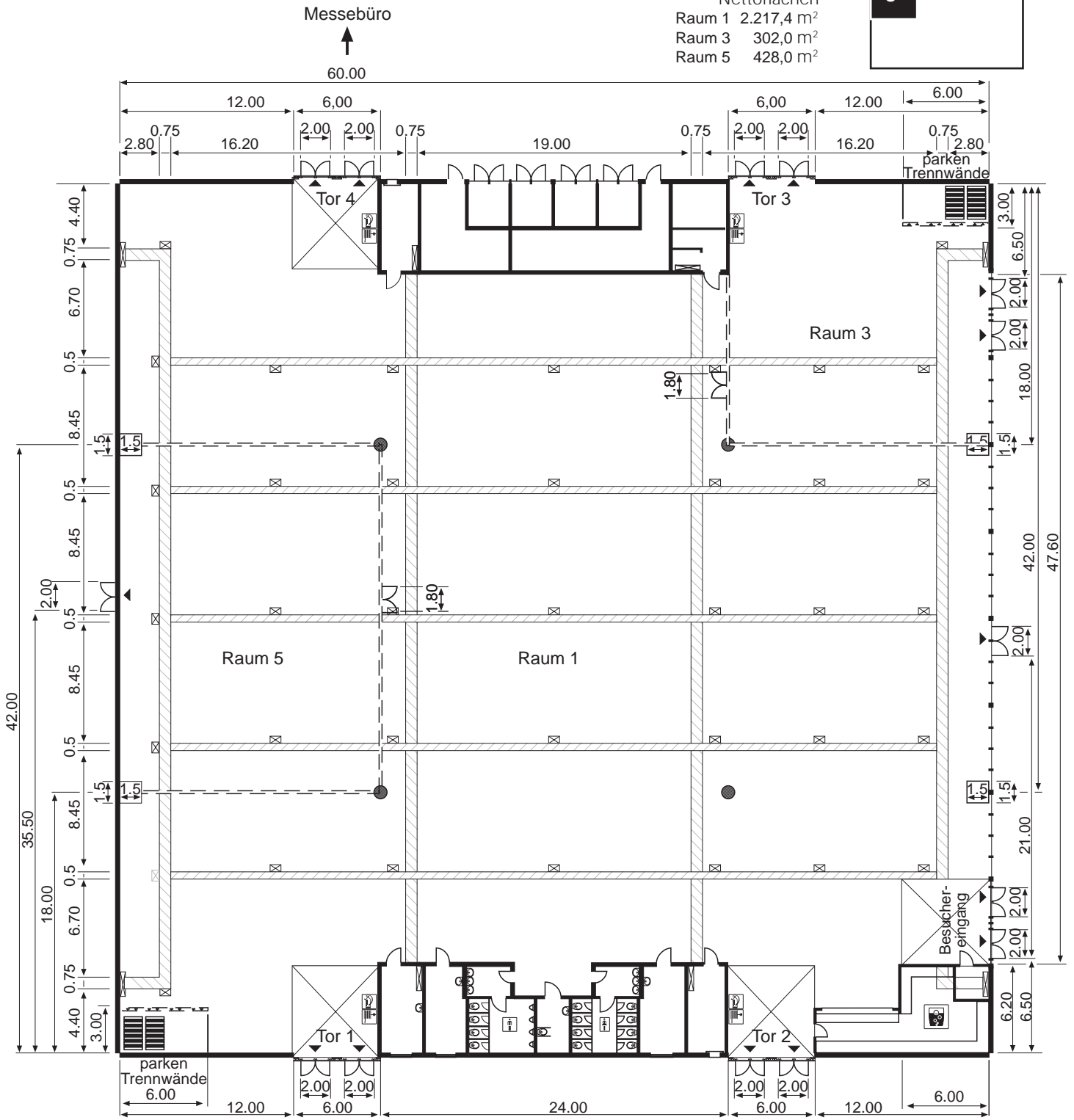

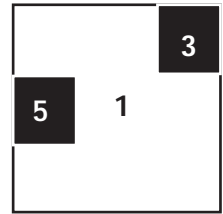

# Die MESSE MAGDEBURG – Halle 1, Raum 1+3+5 – Grundriss mit Medien

Kapazität  
 Bruttofläche  
 60 m x 60 m = 3.600 m<sup>2</sup>  
 Nettoflächen  
 Raum 1 2.217,4 m<sup>2</sup>  
 Raum 3 302,0 m<sup>2</sup>  
 Raum 5 428,0 m<sup>2</sup>



-  Pfeiler  $\varnothing$  0,90 m
-  Tor 1–4 Schiebetoranlage  
lichte Breite x lichte Höhe  
4,90 m x 4,00 m
-  Notausgang  
(6,00 m x 6,00 m)
-  Kabelschacht
-  Wasser- und Abwasseranschluss
-  Trennwände (variabel)
-  Notausgangstüren  
lichte Breite x lichte Höhe  
2,00 m x 2,65 m

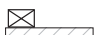
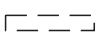
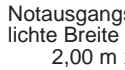