

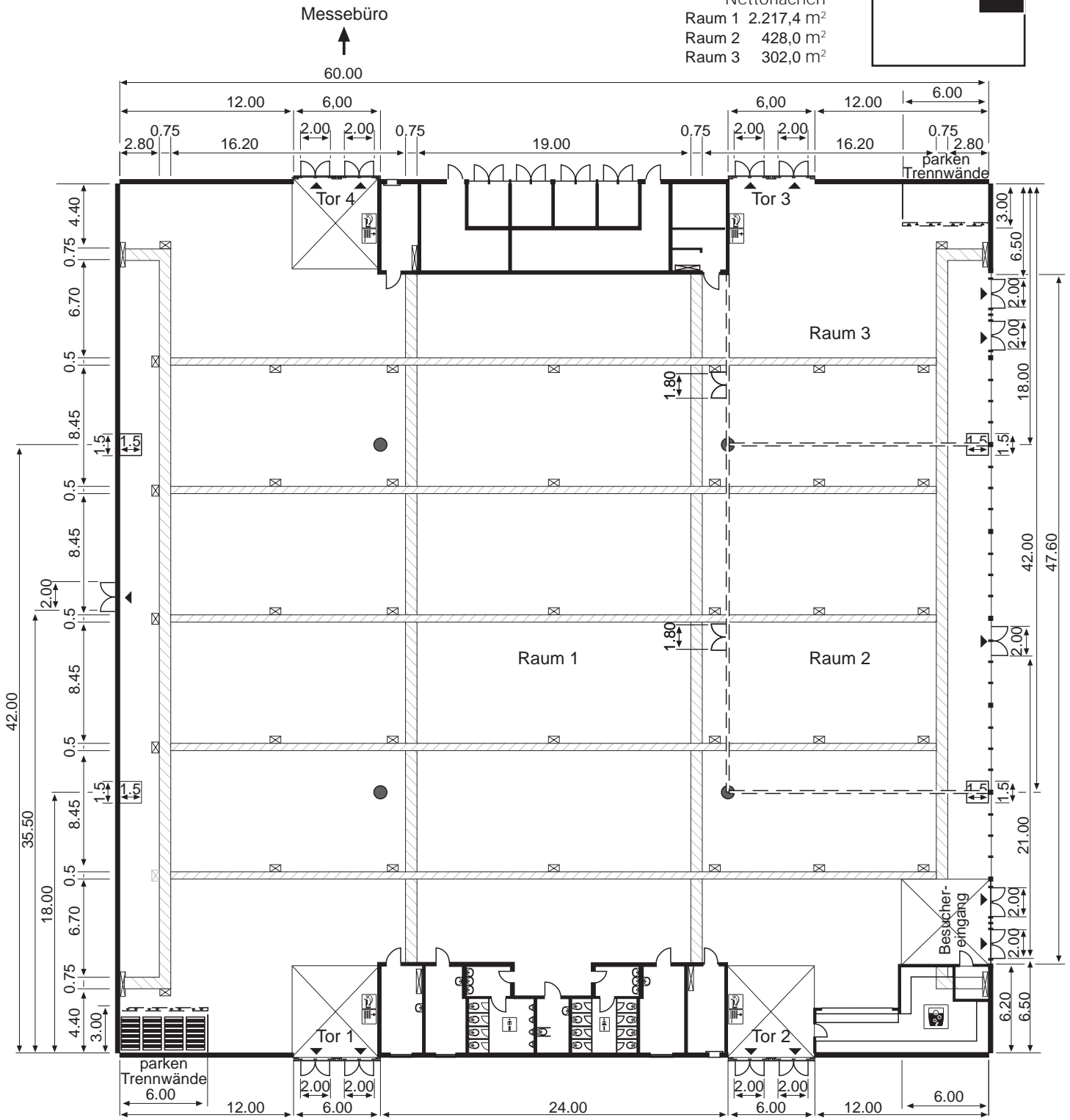

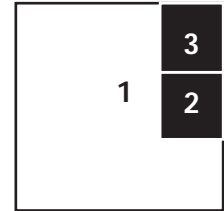

Die MESSE MAGDEBURG – Halle 1, Raum 1+2+3 – Grundriss mit Medien

Kapazität
 Bruttofläche
 60 m x 60 m = 3.600 m²
 Nettoflächen
 Raum 1 2.217,4 m²
 Raum 2 428,0 m²
 Raum 3 302,0 m²



-  Pfeiler \varnothing 0,90 m
-  Tor 1–4 Schiebetoranlage
lichte Breite x lichte Höhe
4,90 m x 4,00 m
-  Notausgang
(6,00 m x 6,00 m)
-  Kabelschacht
-  Wasser- und Abwasseranschluss
-  Trennwände (variabel)
-  Notausgangstüren
lichte Breite x lichte Höhe
2,00 m x 2,65 m

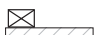
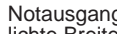
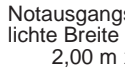